

DETALHAMENTO SALA PSICÓLOGA - ARMÁRIO

**OBS.: TODAS AS CORREDIÇAS
DEVERÃO SER TELESCÓPICAS E
DOBRADIÇAS COM AMORTECEDOR**

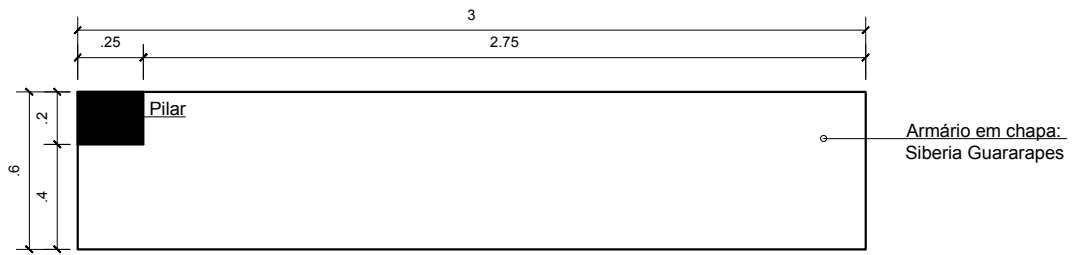

**DETALHAMENTO ARMÁRIO
VISTA SUPERIOR**

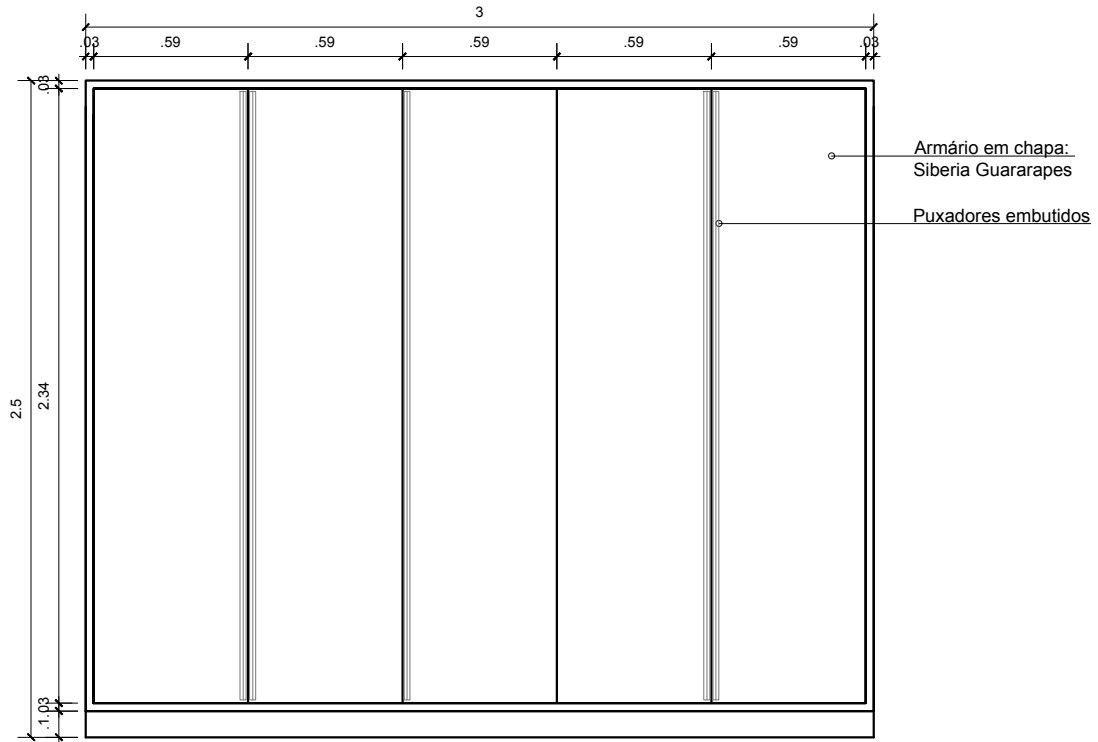

**DETALHAMENTO ARMÁRIO
VISTA FRONTAL**

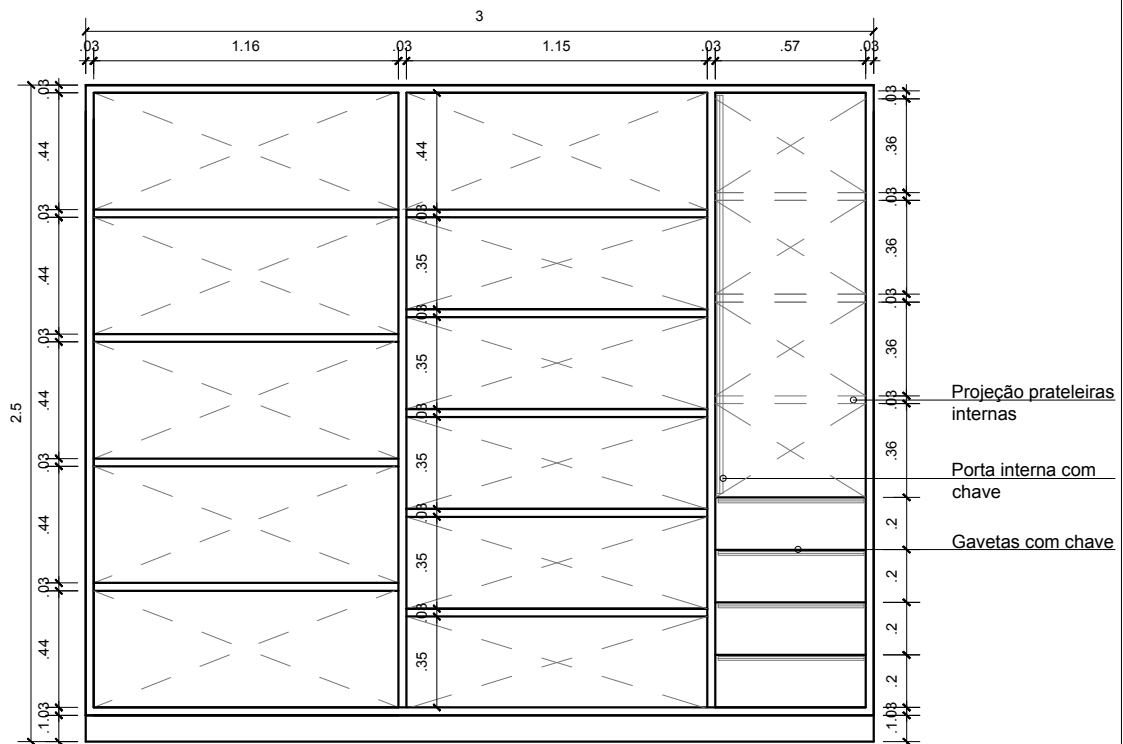

**DETALHAMENTO ARMÁRIO
VISTA FRONTAL - DIVISÓRIA INTERNA**